

## How to Connect to CUSYS Guest Wireless

### PURPOSE:

- How to Connect to the CUSYS Guest wireless network using Android 9 Pie

### HOW TO CONNECT TO CUSYS GUEST WIRELESS:

From the home screen, begin by swiping down from the top to show the Quick Settings Menu.

Long press on the Wi-Fi icon in the top left to show the Wi-Fi settings menu and available Wi-Fi networks. Alternatively, open Settings from the App Drawer, click on Network & Internet and then choose Wi-Fi.

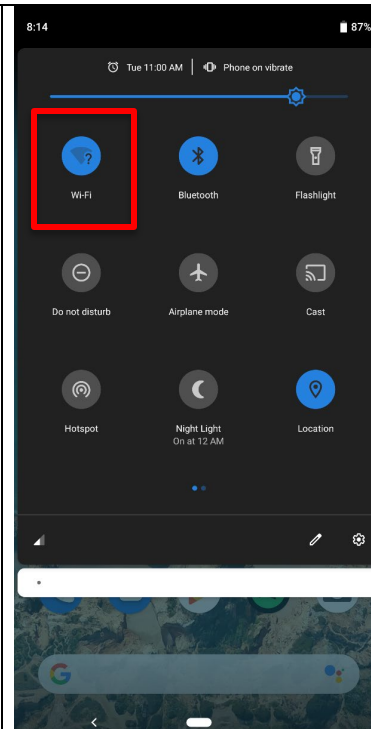

Select CUSYS-Guest from the menu to open the Wi-Fi settings.

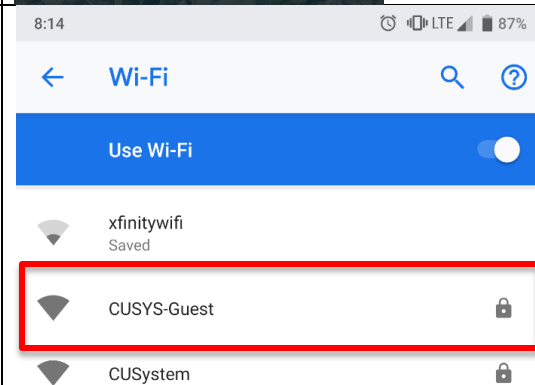

# UIS SERVICE DESK

## WIRELESS & NETWORK

To connect, enter "TheB0ss4cuf!" into the password field with no quotations, using a zero for the "O" in "B0ss". See the example, below.

Once the information above matches the example, click Connect and the screen should change to show the network connecting. It may cycle through saving, obtaining IP address, and connecting before resting on connected. This is normal. The phone should also show a full wi-fi icon in the upper notification bar.

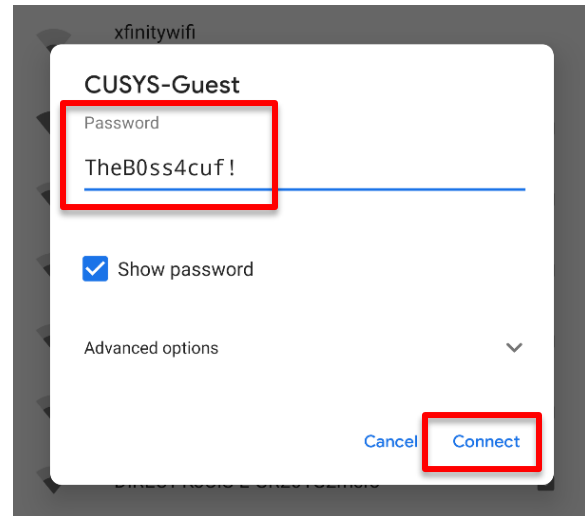

You know you have connected your device to the CUSYS-Guest Wi-Fi when you see the words "Connected" under CUSYS-Guest.

Please follow best practices in browsing and security.

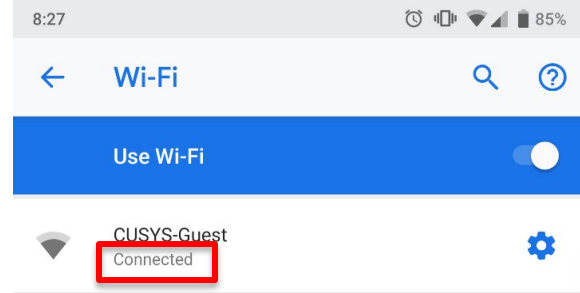

University of Colorado

Boulder | Colorado Springs | Denver | Anschutz Medical Campus

UNIVERSITY INFORMATION SERVICES

### Contact UIS

Call: (303) 860 4357

Email: [help@cu.edu](mailto:help@cu.edu)