

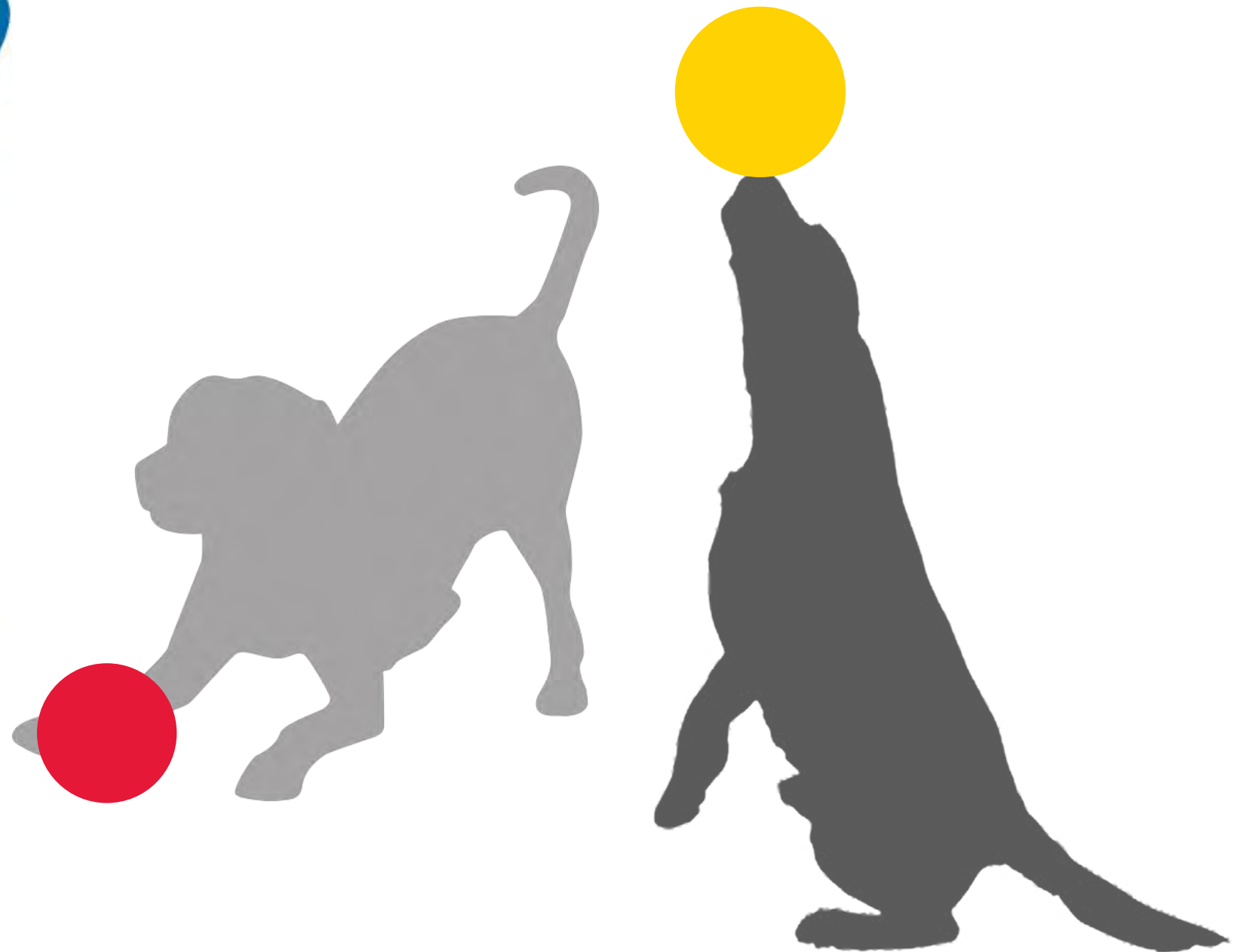

Children's Hospital Colorado
Anschutz Campus
Canine Respite Area



Reason for this project:

Dogs have come to be one of the great hallmarks of Children’s Hospital Colorado, where patients, families, staff, and even team members depend on Medical Dogs and Prescriptions Pets to get them through their hardest days. For these dogs to do their best work, they must also have opportunities to simply be dogs. After a particularly rough bedside procedure or after remaining still and steady for hours to help a patient comply with a test or treatment, the healthiest and most normal thing we can offer our dogs is time to run and play. This helps them re-set and not feel stressed or burned out by what they experience at work. Not only will a fenced space offer normative play for the dogs in a safe and controlled environment, but it will also create opportunities for patients and families to connect with the dogs at play. Hospital therapists can encourage ambulation by scheduling a time for a patient to be outside and watch the dogs play from a nearby bench, and play time can also be broadcast to patient rooms via Seacrest Studio. This will give patients restricted to their rooms by immobility or isolation status the chance to virtually interact with the dogs of CHCO in ways they never have before.

Risk Concerns:

How is the space being controlled from unauthorized use?

This space will have a badge reader, and only handlers and Prescription Pet volunteers would have access.

How is the space being supervised?

Medical Dog handlers and Prescription Pet volunteers will be required to be with their dogs outside, just as they are required inside the hospital.

What policies does CHCO have concerning the space?

The Medical Dog Program Executive Steering Committee will work to draft a policy that will include proper utilization, hours of operation, maintenance, access, and the process for approvals of changes.

What policies, specific to immunizations of the animals will there be for this space?

Medical Dogs and Prescription Pet dogs’ immunizations are closely monitored through the hospital; these immunizations will be sufficient for outdoor play.

Use of Space:

What dogs will be using this space? Will service animals be allowed to use this space?

Medical Dogs and Prescription Pet Program dogs will be the only animals allowed to use this space. We will not allow service animals.

What are the hours of this space?

8:00 am - 8:00 pm, seven days per week.

What is the cleanup policy of the dogs (in terms of per dog, and for the entire space)?

Every dog owner/handler will clean up feces immediately. The plans also include a hose hookup available to wash down the area. These dogs are screened for intestinal parasites, so there should be no worries about ground contamination with parasites. For the entire space, our facilities team will be responsible for managing waste receptacles.

How many dogs may use this space?

This is ultimately dependent on square footage allocated for the space. Dog daycare recommendations are 300 square feet per large dog. We would follow that recommendation. Additionally, handlers and volunteers would closely monitor whether dogs have enough room while they are actively playing.

What is the reasoning behind the size of this space?

More space is better and makes it easier to build more natural looking structures which are appropriate for both large and small dogs. Additionally, more space allows for more active play which is important for the dogs during their respite recovery period. Aesthetically, if we can get the entire area fenced, it would look a lot cleaner and be less likely to require an expansion as we add dogs to the program.

Design of Space:

What is the recommended fence height?

A 6-foot fence makes the most sense in terms of containment and discouraging anyone from climbing it. In addition on the north and west edges a tall plant-material hedge for screening has been incorporated into the plans.

Are there any plants that are important to avoid?

Plantings to enhance the exterior of the area are important. There are lists of toxic plants readily available through the Animal Poison Control Center.

What will the structured play items look like?

All structured play elements will look natural, and there will be space for dogs to run and exercise. We have contacted two facilities regarding play elements: The Hill’s Pet Food Research group, and the Royal Canin Global Innovation Centers. Each has built some interesting structures to provide enrichment, which include climbing stairs, tunnels and puzzles, and their input has been layered into the design.





CHILDREN'S HOSPITAL CANINE RESPITE AREA CONTEXT MAP

1 September 2020

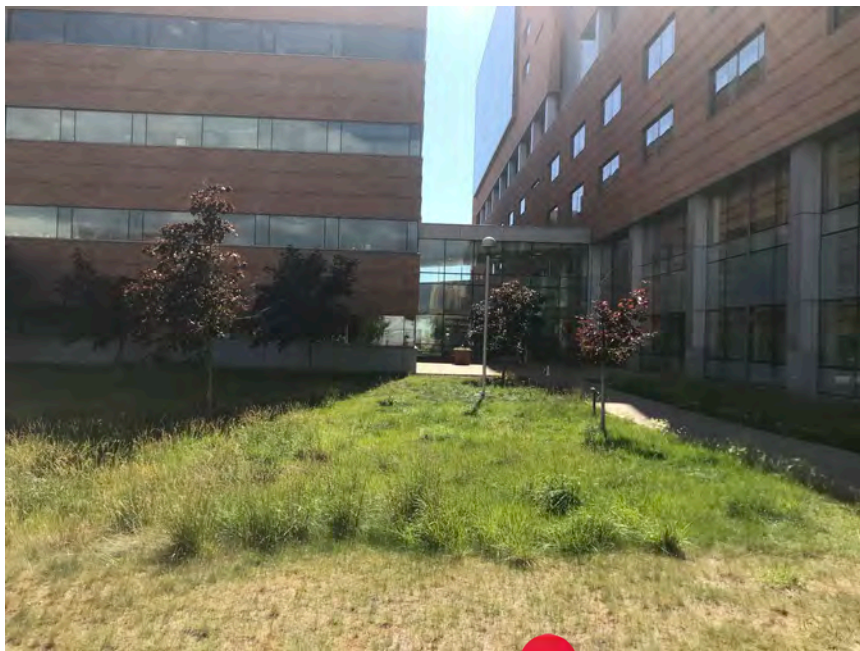

CHILDREN'S HOSPITAL CANINE RESPITE AREA **EXISTING SITE PHOTOS**

1 September 2020



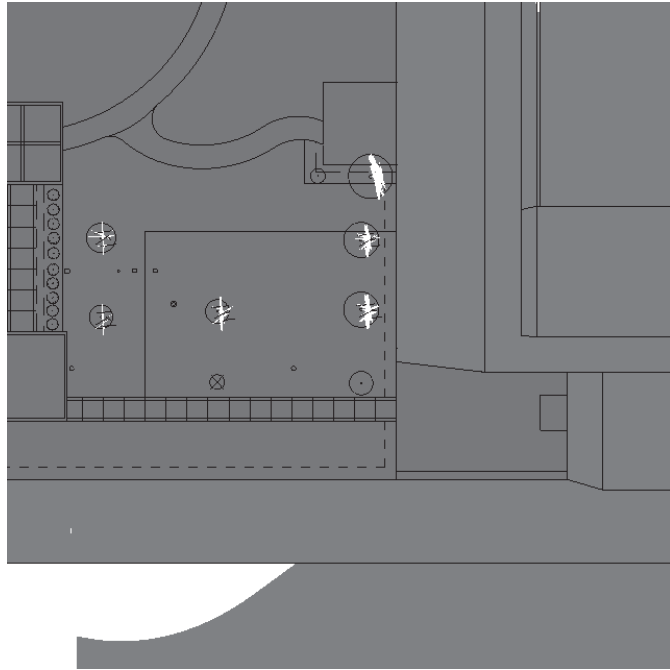

21 DECEMBER: 12:00

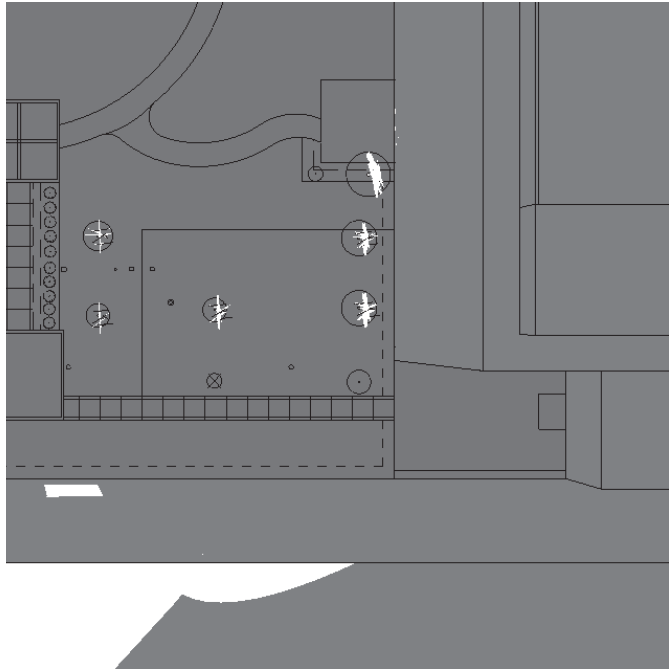

21 DECEMBER: 15:00

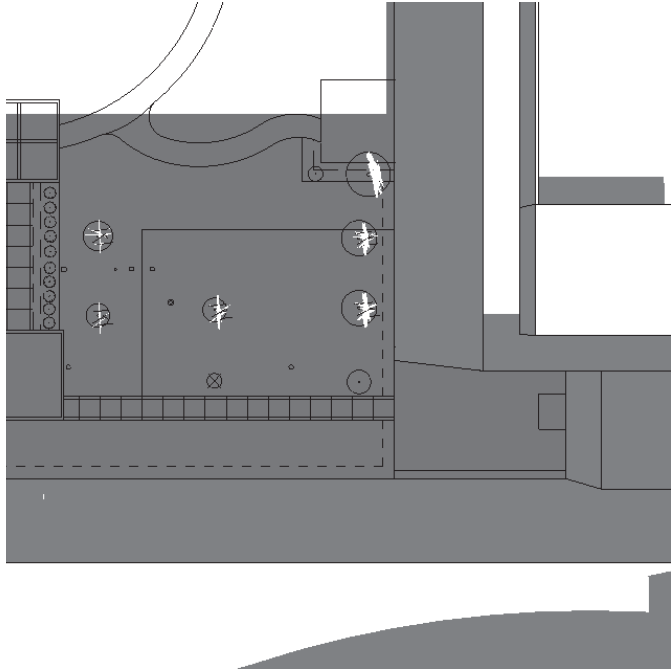

21 MARCH: 12:00

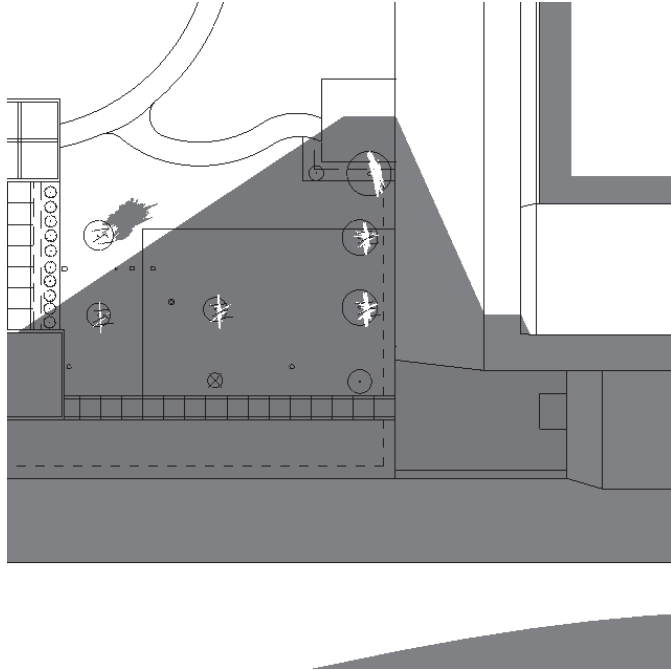

21 MARCH: 15:00

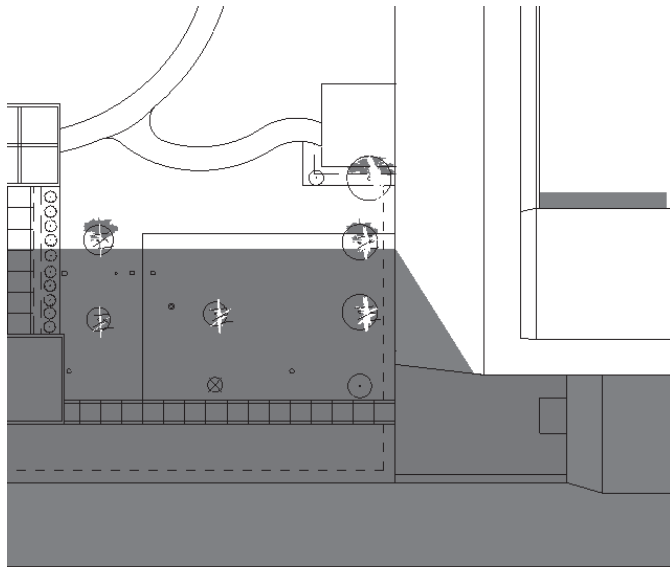

21 APRIL: 12:00

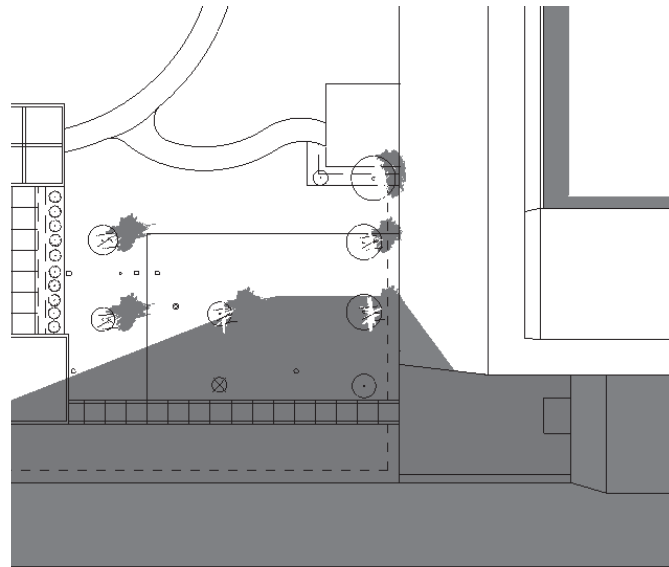

21 APRIL: 15:00

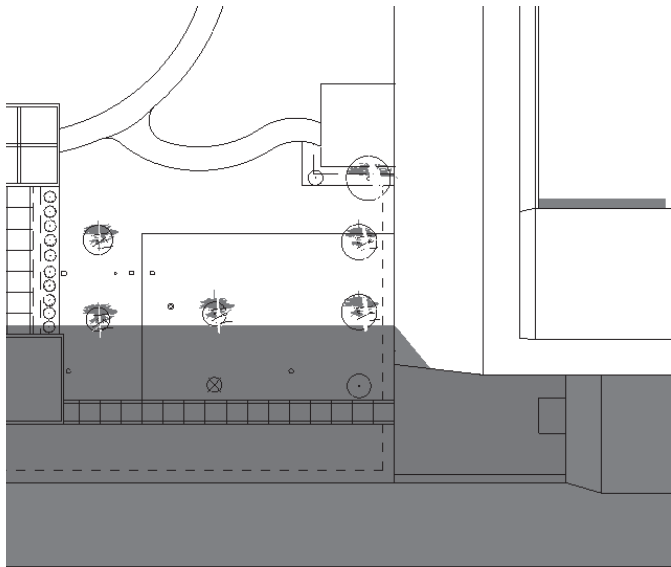

21 MAY: 12:00

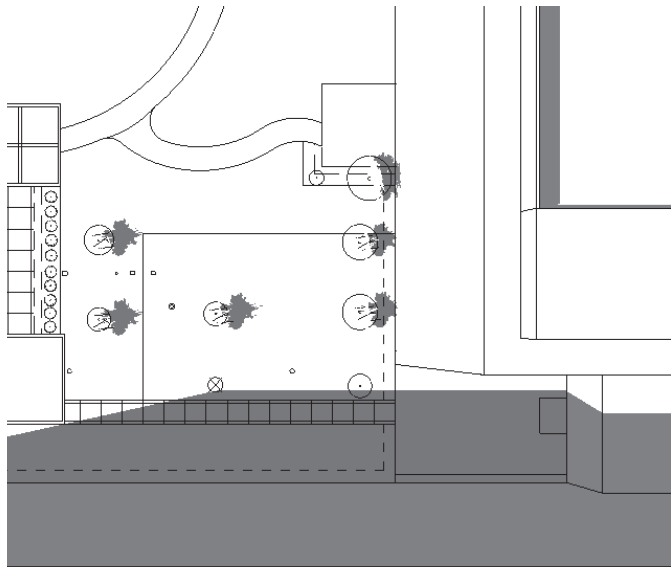

21 MAY: 15:00

CHILDREN'S HOSPITAL CANINE RESPITE AREA **SUN / SHADE STUDY**

1 September 2020



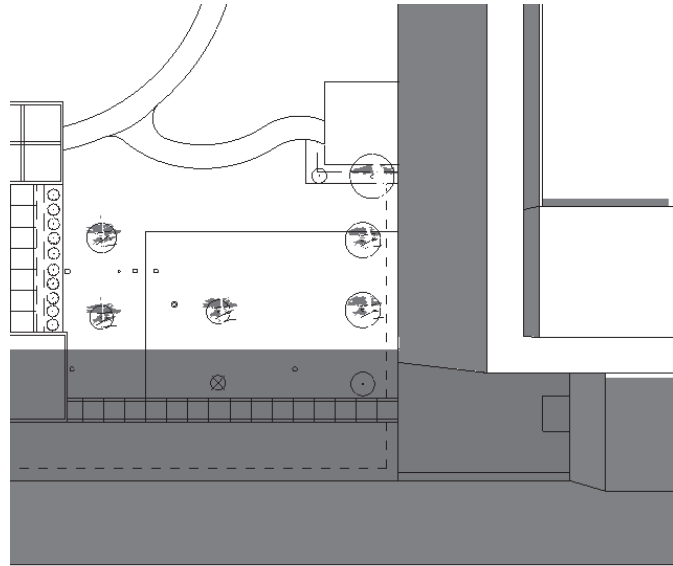

21 JUNE: 12:00

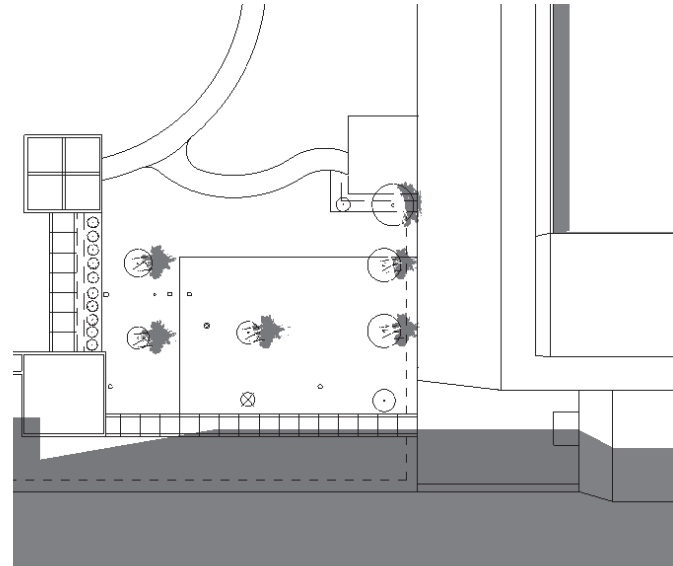

21 JUNE: 15:00

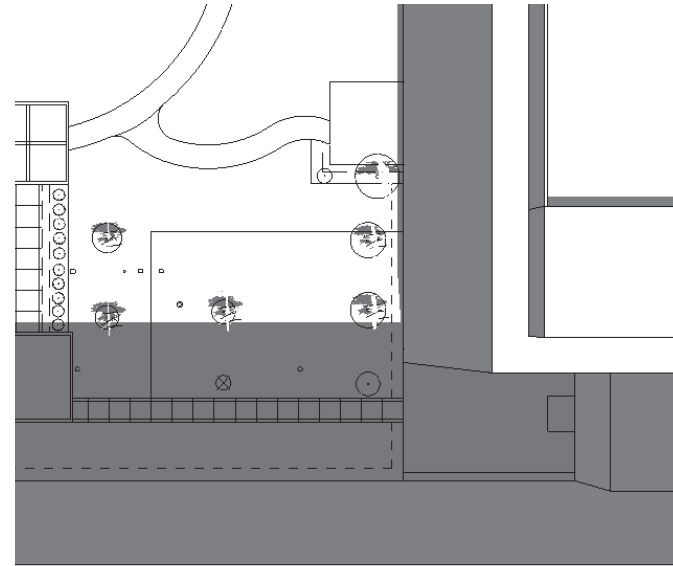

21 JULY: 12:00

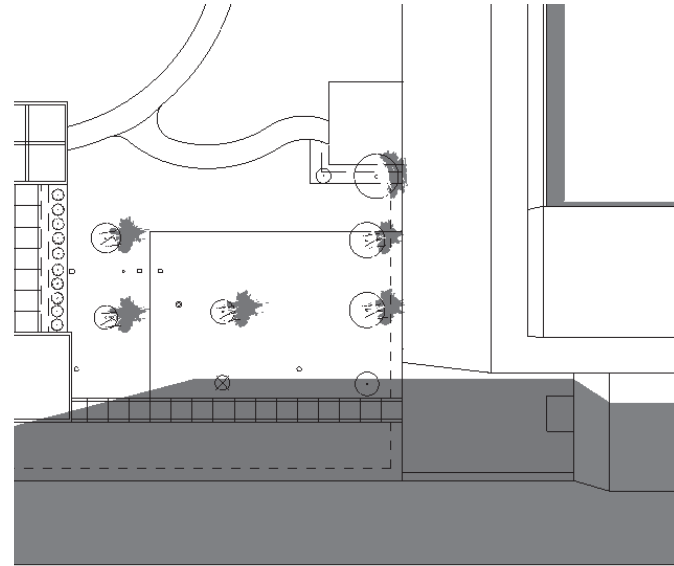

21 JULY: 15:00

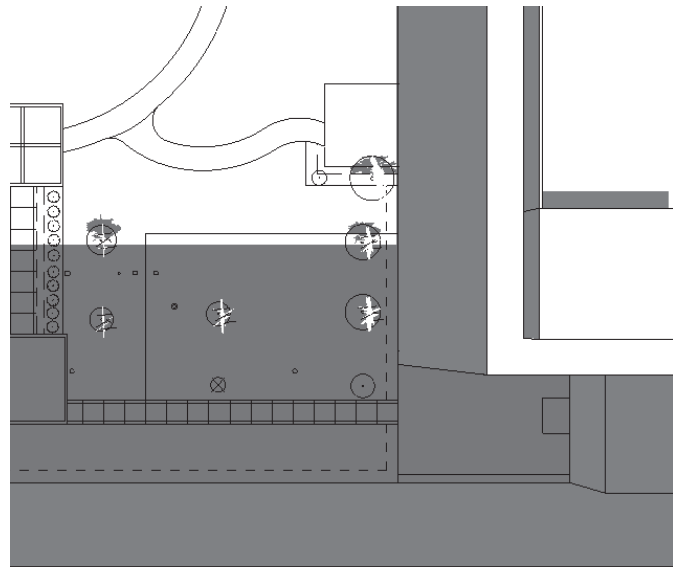

21 AUGUST: 12:00

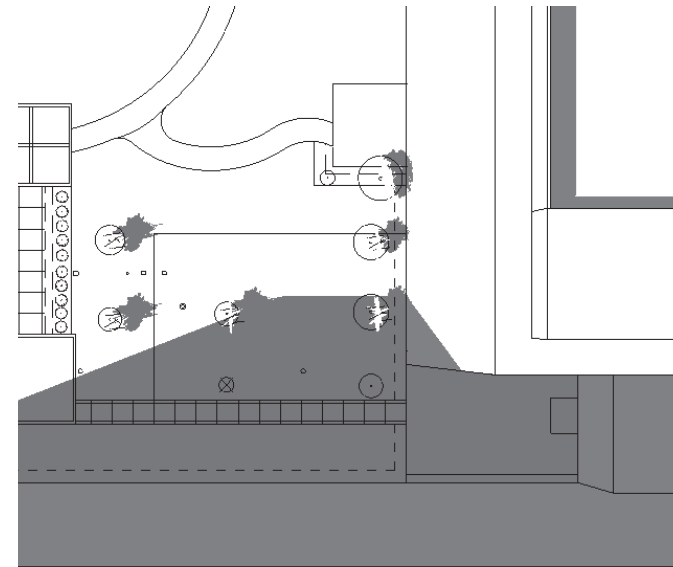

21 AUGUST: 15:00

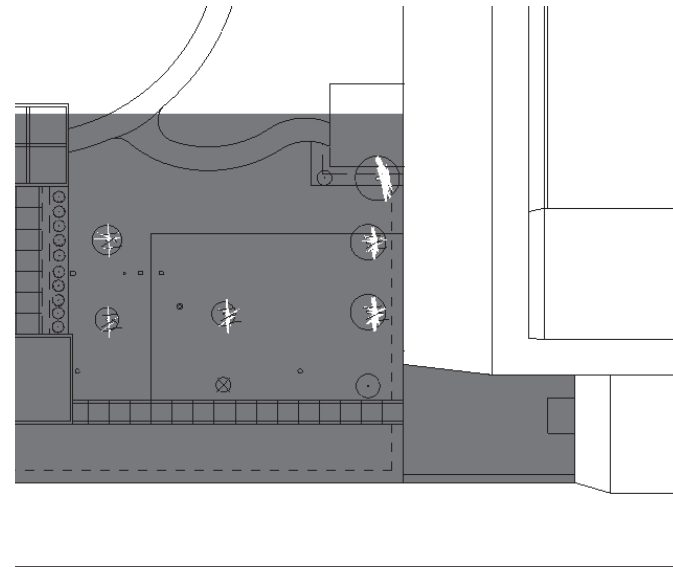

21 SEPTEMBER: 12:00

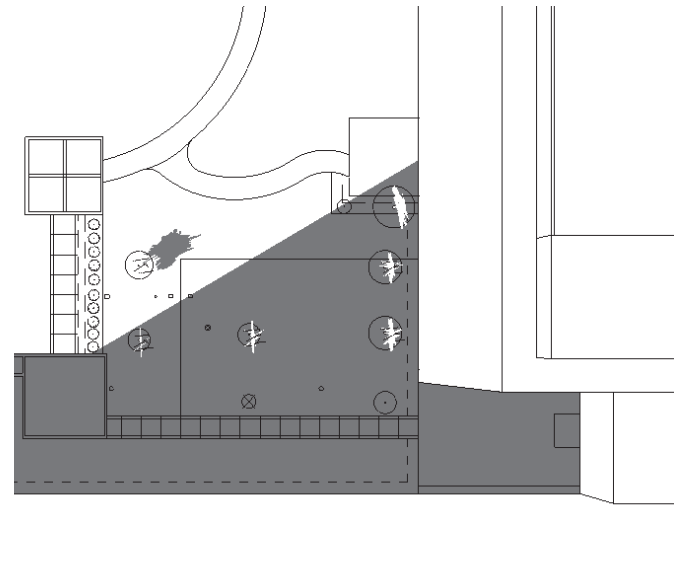

21 SEPTEMBER: 15:00

CHILDREN'S HOSPITAL CANINE RESPITE AREA **SUN / SHADE STUDY**

1 September 2020



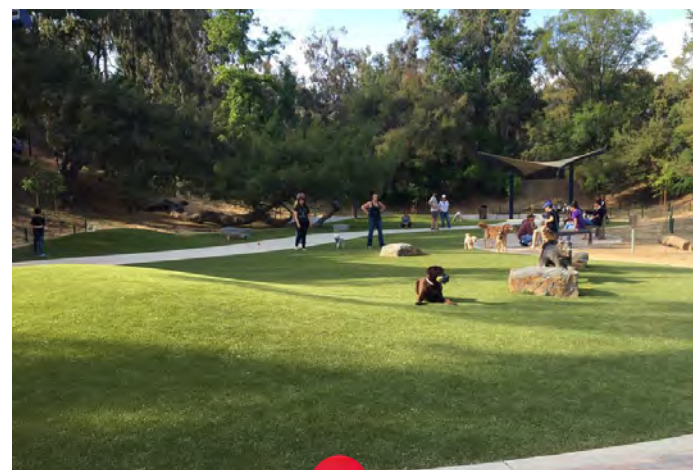
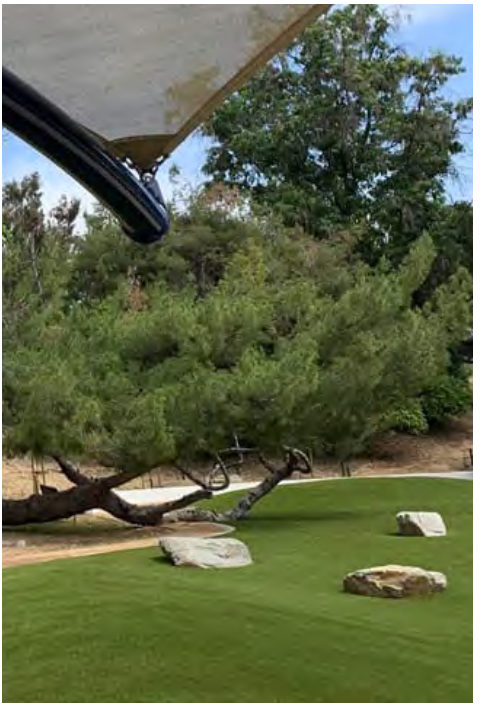

CHILDREN'S HOSPITAL CANINE RESPITE AREA DOG PARK PRECEDENTS

1 September 2020

EARLY IN THE DESIGN PROCESS,
we consulted a variety of studies and research regarding the design of dog parks, and what elements had the greatest positive impacts upon human and canine user experiences and safety.

THE PROPOSED THERAPY DOG AREA
at the Children’s Hospital is unique from most dog exercise parks in that it is not open to the public, and there will be a maximum of 6-8 therapy dogs using the space at one time. Unlike the varied canine users of public dog parks, the hospital therapy dogs are of similar breeds and sizes. With this in mind, we have considered the following design recommendations identified by a variety of dog park studies and user surveys that are most relevant to the proposed Children’s Hospital Therapy Dog Area.

ACCORDING TO A VARIETY OF SURVEY RESULTS,
important design considerations relevant to the proposed Therapy Dog Area include the following:



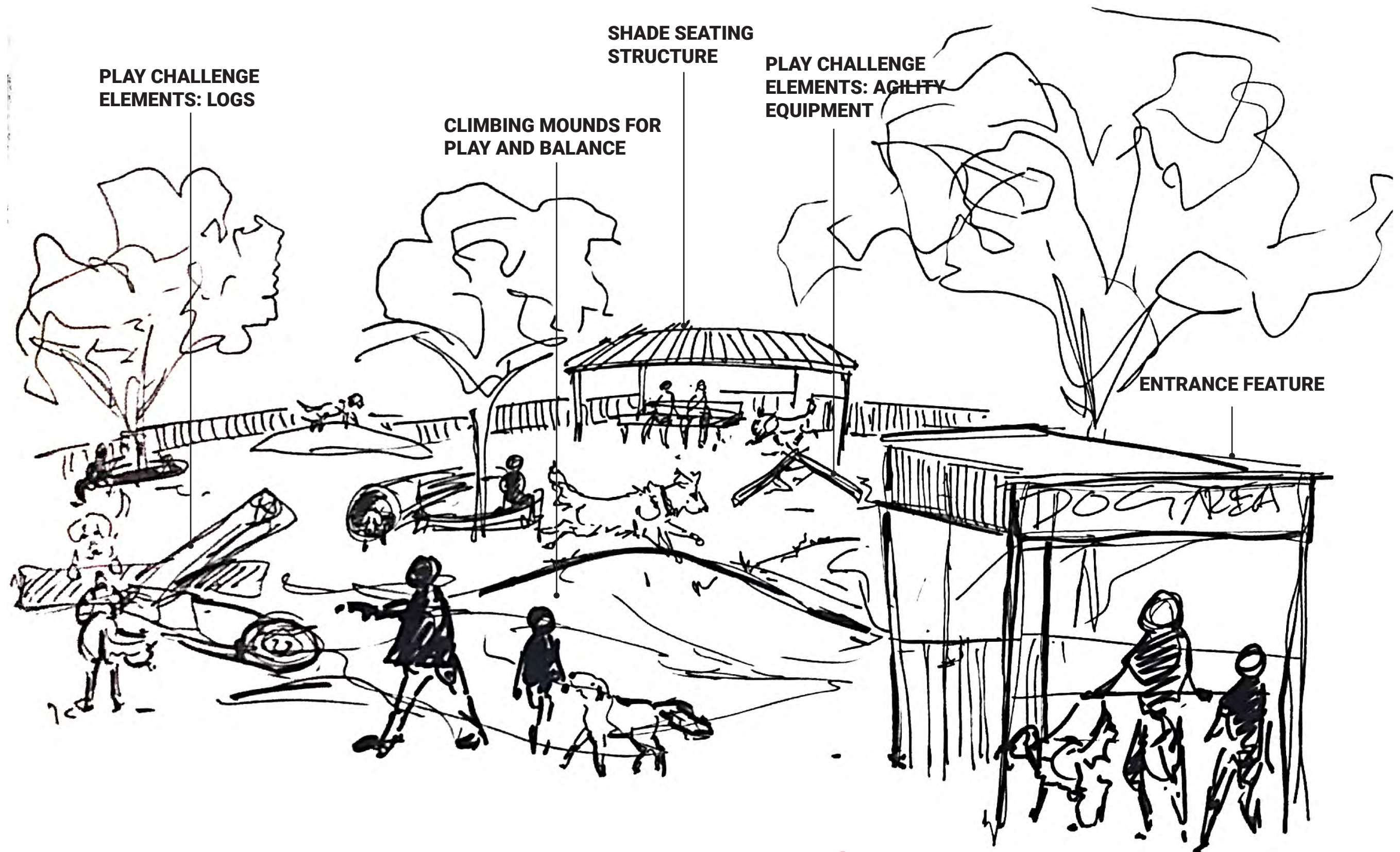

CHILDREN'S HOSPITAL CANINE RESPITE AREA CONCEPT SKETCH

1 September 2020



Children's Hospital Colorado

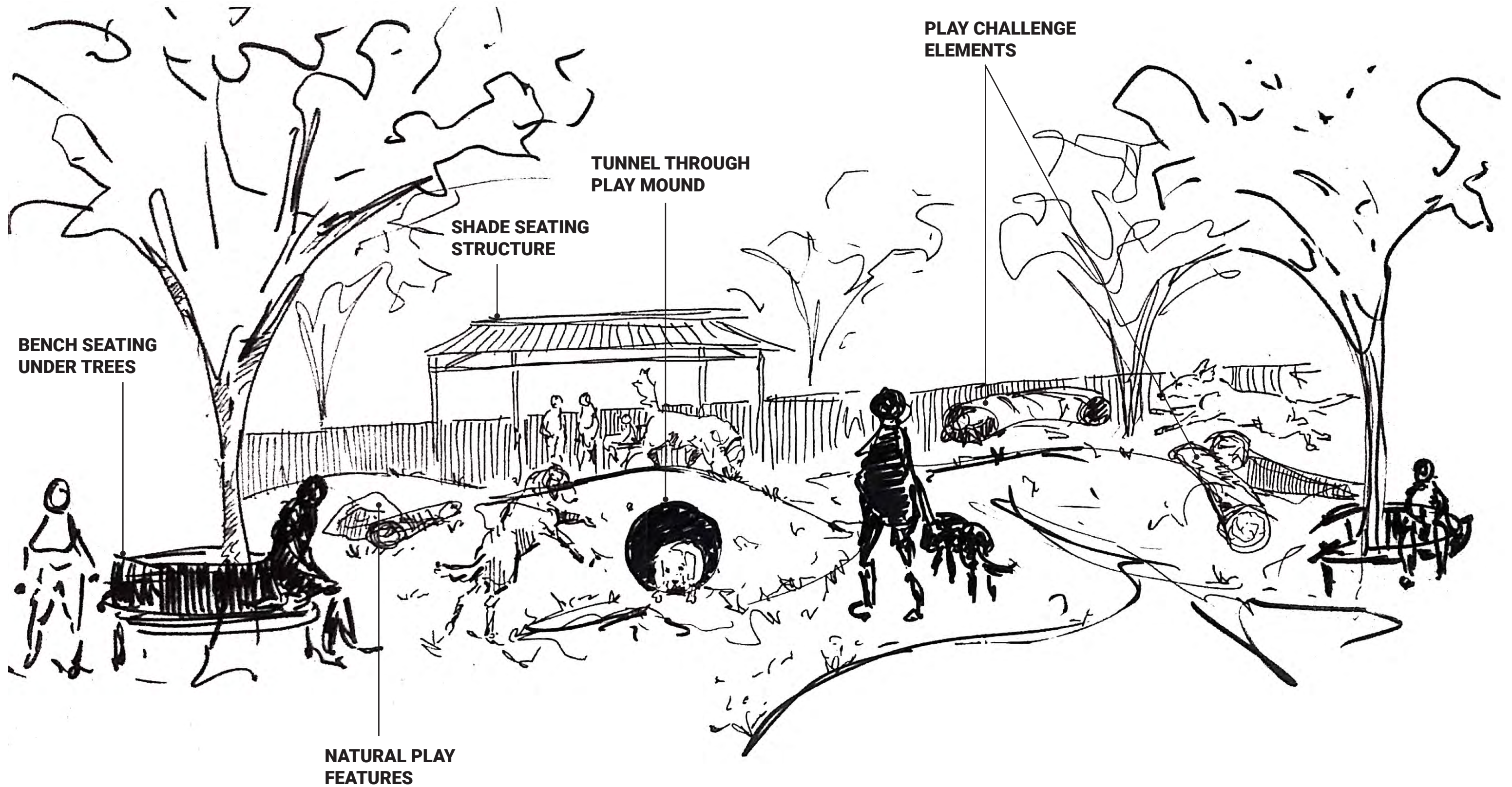

CHILDREN'S HOSPITAL CANINE RESPITE AREA CONCEPT SKETCH

1 September 2020



Children's Hospital Colorado



CHILDREN'S HOSPITAL CANINE RESPITE AREA **DESIGN DIAGRAM**

1 September 2020



Children's Hospital Colorado

N.T.S. NORTH



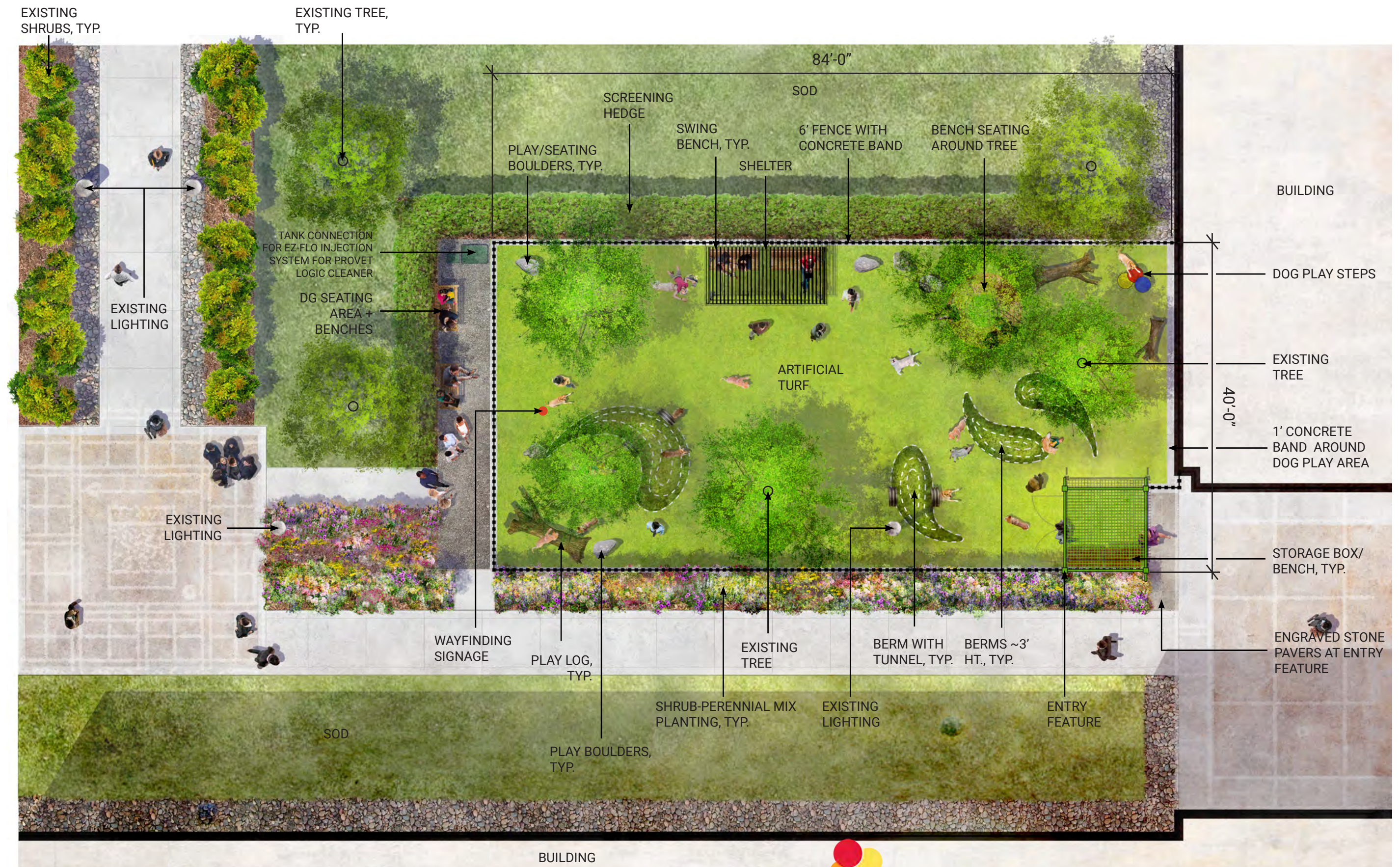

CHILDREN'S HOSPITAL CANINE RESPITE AREA ILLUSTRATIVE PLAN

1 September 2020



Children's Hospital Colorado

N.T.S.



Dig
Studio
1001 15TH STREET, DENVER, COLORADO 80202
P: 724.261.1000 | www.digstudio.com



CHILDREN'S HOSPITAL CANINE RESPITE AREA **VIEW FROM E. 17TH AVE.**

1 September 2020



Children's Hospital Colorado

Dig
Studio
1881 15TH STREET, DENVER, COLORADO 80202
P: 724.261.1000 | www.digstudio.com

STRUCTURES

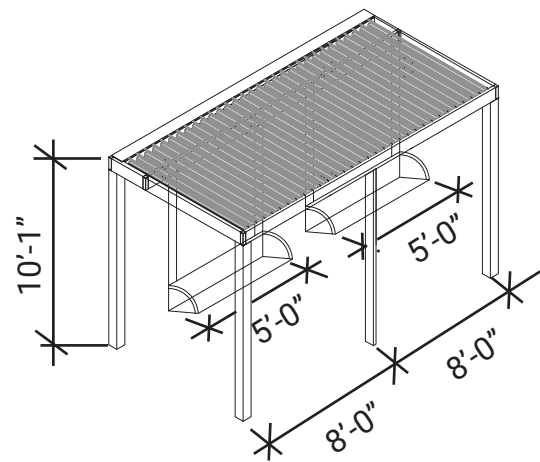

UpFit | Landscape Forms

Base unit = 16' x 16' x 10'

Modular system of posts, beams, roofing, panels, and tables



Character Image

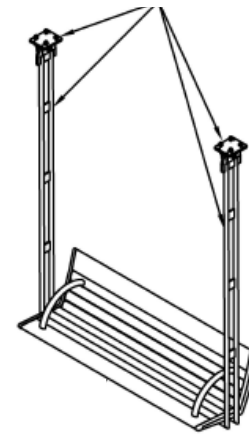

Austin Swing Bench + Suspension Kit | Landscape Forms

48"-72" L x 22 13/16" H; To go under shelter

Thermally Modified Ash (DSTMA)

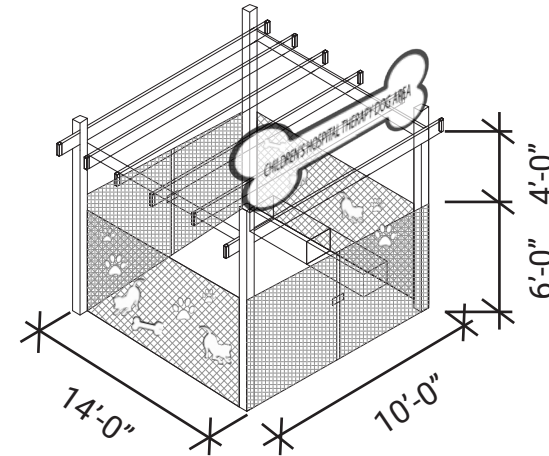

Entry Feature | Custom

To be designed after the existing entry feature for the Hospital Garden



Character image of existing Garden Entryway structure

FURNISHINGS



Neoliviano Bench | Landscape Forms

69" Backed Style; 27" H x 69" L x 31" W
Thermally Modified Ash (DSTMA)



Somerset Storage Box | Westminster Teak

60" L x 25.25" W x 24" H
100% Grade A Plantation Teak



Link Bench | Landscape Forms

96" radius Piano Key + Custom radius, Partial Backed (inside radius), no arms
31.5" W x 85" W segments

Thermally Modified Ash (DSTMA); Black Powdercoated Metal

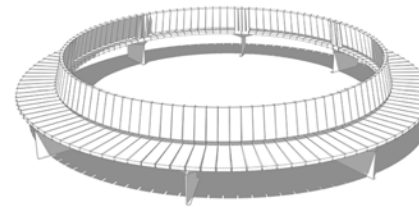

FENCING



TufGrid | Merchant Metals

Black; 6' H

6-gauge horizontal + vertical steel wire with TGIC polyester powder coat finish



TufGrid Double-Swing Gate | Merchant Metals

Character image of existing fence at Children's Colorado Healthy Roots Community Garden

CHILDREN'S HOSPITAL CANINE RESPITE AREA PRODUCT/FURNISHING

1 September 2020



Children's Hospital Colorado



SURFACE MATERIALS



SynLawn Pet Platinum | SynLawn
15/18 pp 2-Part/20 oz. EnviroLoc backing; Sanitized, EnviroLoc, StatBlock, Anti-Static, DualChill IR Reflective, Deluster, UV Stabilizers; Ultra-durable Super Yarn construction to eliminate digging, brown spots, etc.; 1 1/2" H



Engraved Stone Pavers at Entry Feature
Character Image

WAYFINDING



Wayfinding Sign | Custom
To be designed after the existing entry feature for the Hospital Garden

SCREENING



Screening Hedge
Cotoneaster acutifolius; 5' W x 6-10' H



Screening Hedge
Cotoneaster acutifolius; Winter Condition

Landscape Narrative

The plant material proposed for the Children's Hospital Canine Area is designed to address three purposes:

- The addition of 3 deciduous trees within the respite area to provide shade for the dogs and handlers while recalling the original tree bosque design idea
- The placement of a hedge along the north and west edges of the fence line to visually screen the dog park area from 17th Ave and the entry walk and parking areas to the west
- Along the east/west walkway between the lobby to the east and the north entrance a planting bed with perennials and ornamental grasses will provide year round texture and seasonal color.

DOG PLAY EQUIPMENT



Berm with Tunnel | Custom
Character Image
Berms = ~3' H

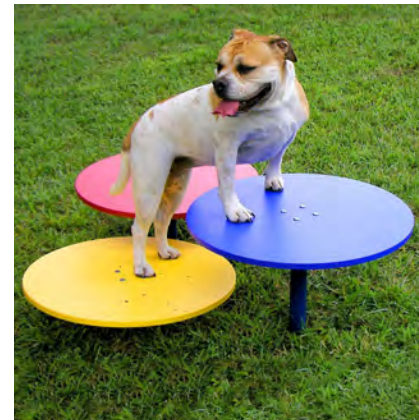

Dog Play Steps | Custom
Character Image; Hospital Colors



Nature Bark Stepping Boulders | Park Warehouse
Set of 3; sizes vary ~2'6" L x 2'1" W x 18" H; UV-resistant Glass Fiber Reinforced Concrete



Log Dog Play Feature | Locally Sourced Salvaged Tree Trunk
Character Images; ~10-12' L x ~18" H



CHILDREN'S HOSPITAL CANINE RESPITE AREA PRODUCT/FURNISHING



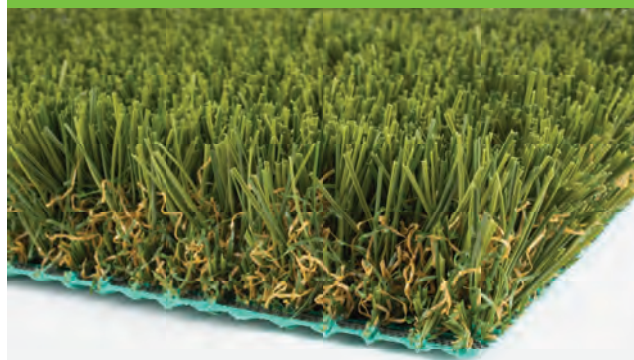



1 September 2020



SYNLawn Pet Platinum

The ultimate artificial grass designed for pets of all shapes and sizes. With maximum drainage built-in, cleanup is a breeze. Ultra-durable Super Yarn™ construction eliminates digging, brown spots, and other common problems found in backyards and pet facilities.

Grass Zone Yarn/Color	PE / Field Green / Apple
Grass Zone Denier	10,000 / 6
Thatch Zone Yarn/Color	PE / Field Green / Beige
Thatch Zone Denier	5,040 / 12
Grass Zone Yarn Shape	Omega
Finished Pile Height	1 1/2"
Finished Pile Weight	80 oz.
Backing	15 / 18 PP 2-Part / 20oz. EnviroLoc™
Tuft Gauge	3/8"
Total Weight	106 oz.
Tuft Bind	> 8 lbs.
Permeability	> 1,200 inches per / SY
Features	Sanitized®, EnviroLoc™, StatBlock™ Anti-Static, DualChill™ IR Reflective, Deluster, UV Stabilizers
Test Data	ASTM E108 Class A Fire Rating, F1292, F1551, F1951

 Unmatched Lifetime Warranty	 Foot Traffic  Softness
 EnviroLoc™ Plant-Based Backing	
 Deluster and UV Protection	
 Class A Fire Rating	

SUPER YARN™ TECHNOLOGY

Sanitized® Antimicrobial DualChill™ IR Reflective StatBlock™ Anti-Static



Learn more at CADdetails.com

Not to scale. For illustration only.

RECOMMENDED USES

PETS — LANDSCAPE — PLAY — ROOFTOP

SynLawn Pet Platinum

- Strongest fiber for durability on the market
- Constructed with anti-microbial Super Yarn Technology
- Super Yarn construction also eliminates digging, brown spots and other common problems found in pet facilities
- Infill: EnviroFill at 2 lbs.
- Maintenance-free
- Built-in maximum drainage to increase site drainage
- Antimicrobial product
- Does not compact or clog drainage
- High wear-resistance and realistic appearance
- *Cleaning solution:* Pro-Vet Logic, installed with the EZ-FLO System

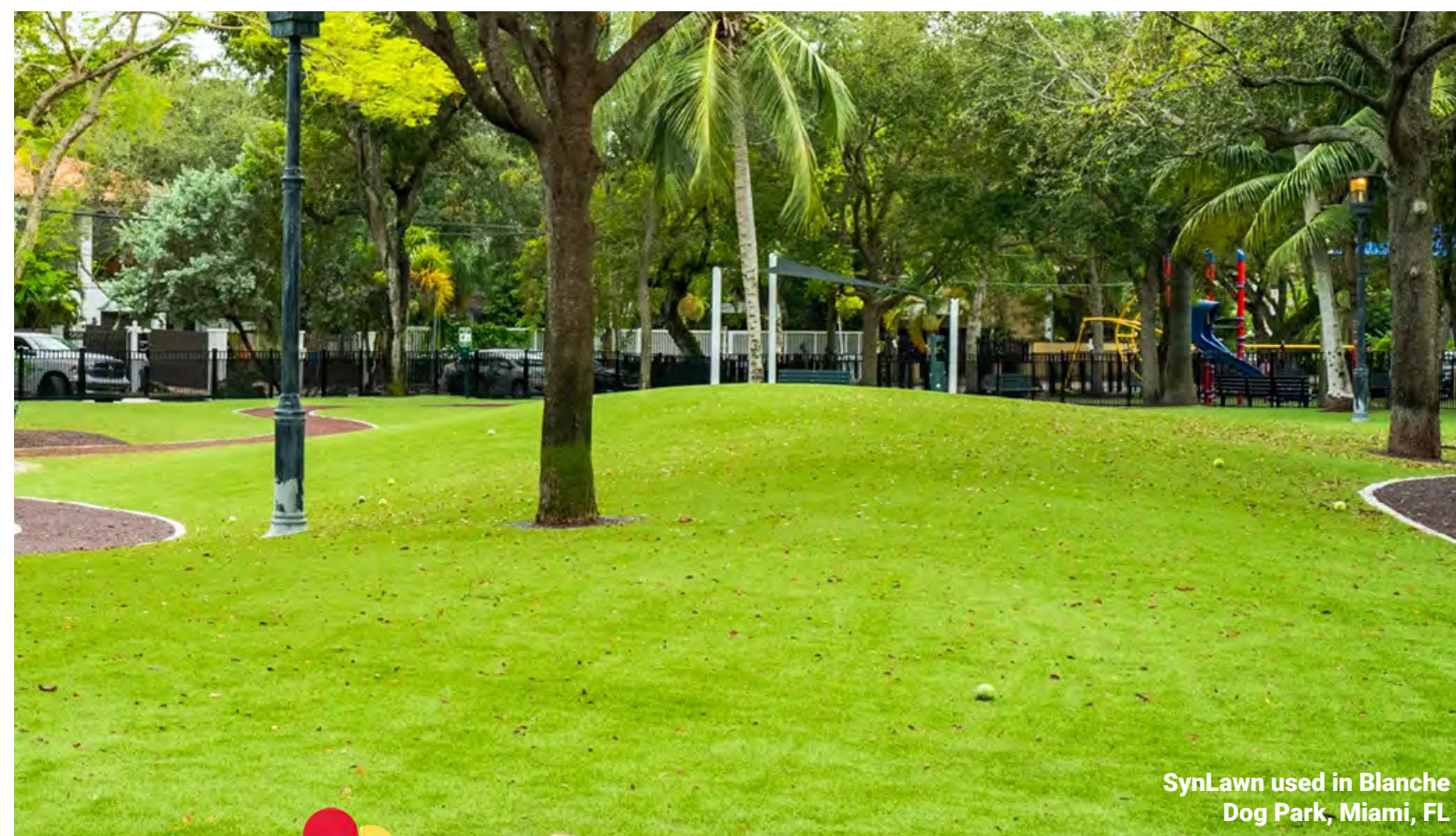

SynLawn used in Blanche Dog Park, Miami, FL

CHILDREN'S HOSPITAL CANINE RESPITE AREA ARTIFICIAL TURF

1 September 2020



A Green Solutions Company™

INSTALLATION AND OPERATING GUIDE MAINLINE SYSTEMS



For an overview of the EZ-FLO System
Installation & operation:

www.ezfloinjection.com/videos/

*** IMPORTANT ***
READ INSTRUCTIONS BEFORE INSTALLING THE SYSTEM
TO INSURE PROPER INSTALLATION

EZ-FLO Coupling Ball Valve Required for Installation
Sold Separately

- Do not connect to an irrigation system that is not protected by an approved back flow prevention device.
- Do not install if pressure exceeds 80 PSI
- Use only with non-hazardous products
- Minimize exposure to direct sunlight to maximize service life
- Protect against freezing to avoid tank fracture

© 2018, EZ-FLO™ Fertilizing Systems

System Installation

Typical installation

The system is normally installed in a valve box, connected to the main line of the irrigation system after the back flow preventer and before the sprinkler valves. One unit will feed both drip and sprinkler zones without changing any connections or nozzles. It will feed both the front and back yard landscapes.

